

PRINTED 6/1/2023
THESE DRAWINGS AND PLANS, ANY REPRODUCTION THEREOF, AND ANY CAD OR ELECTRONIC FILE OF THESE DRAWINGS OR PLANS, ARE THE SOLE AND EXCLUSIVE PROPERTY OF BGD ARCHITECTS, P.A. AND MAY NOT BE REPRODUCED, PUBLISHED, MIMICED OR USED IN ANY MANNER WITHOUT THE EXPRESS WRITTEN PERMISSION OF BGD ARCHITECTS, P.A. USE OF THESE PLANS FOR CONSTRUCTION SHALL BE CONSIDERED ACCEPTANCE OF THE TERMS CONTAINED HEREIN AND THE LIABILITY AND CONSTRUCTION OF THE PLANS. THE PLANS SHALL NOT BE CALLED OR
AND SHALL BE THE FULL AND COMPLETE RELEASE OF BGD ARCHITECTS, P.A. FROM ANY LIABILITY, CLAIMS, OR DAMAGES INCLUDING TRINIS AND OMISSIONS ARISING OUT OF OR RELATED TO THE PLANS. ANY DISCREPANCIES OR CONFLICTS IN THE PLANS SHALL BE REFERRED IMMEDIATELY TO BGD ARCHITECTS FOR CLARIFICATION PRIOR TO CONTINUING WITH THE WORK. FAILURE TO REFER DISCREPANCIES OR CONFLICTS TO BGD ARCHITECTS SHALL BE AT THE USER'S SOLE RISK AND WITHOUT LIABILITY TO BGD ARCHITECTS, P.A.
KPI ENGINEERING, INC. PROFESSIONAL ENGINEERS
"No matter the Scope, KPI has YOU Covered!"
3303 QUEEN PALM DRIVE
TAMPA, FLORIDA 33619
PHONE: (813) 241-6488
FAX: (813) 241-6488
BOARD OF PROFESSIONAL ENGINEERS - LICENSE # C-4470

DUCTWORK #2 FRONT VIEW

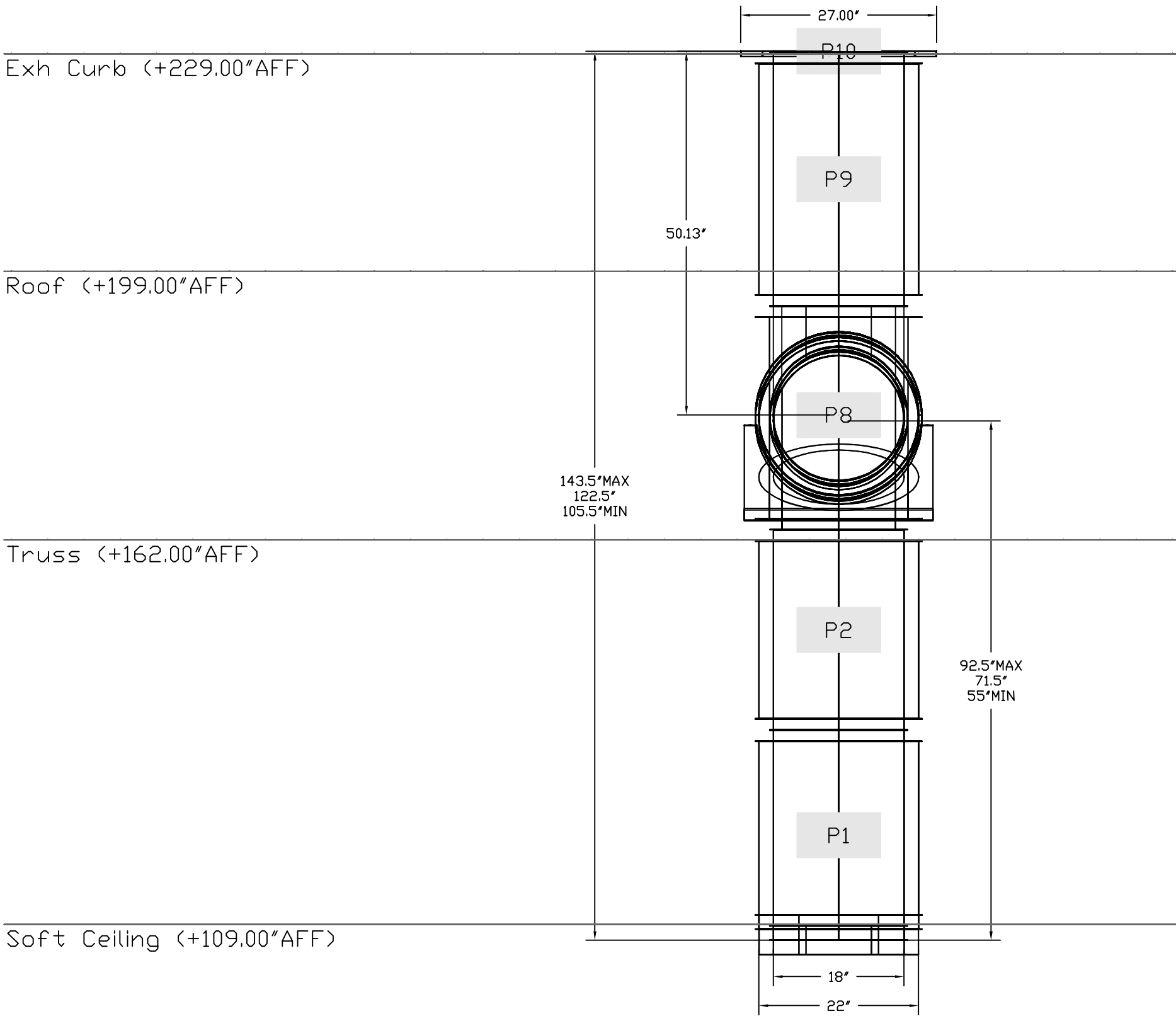

DUCTWORK #2 SIDE VIEW

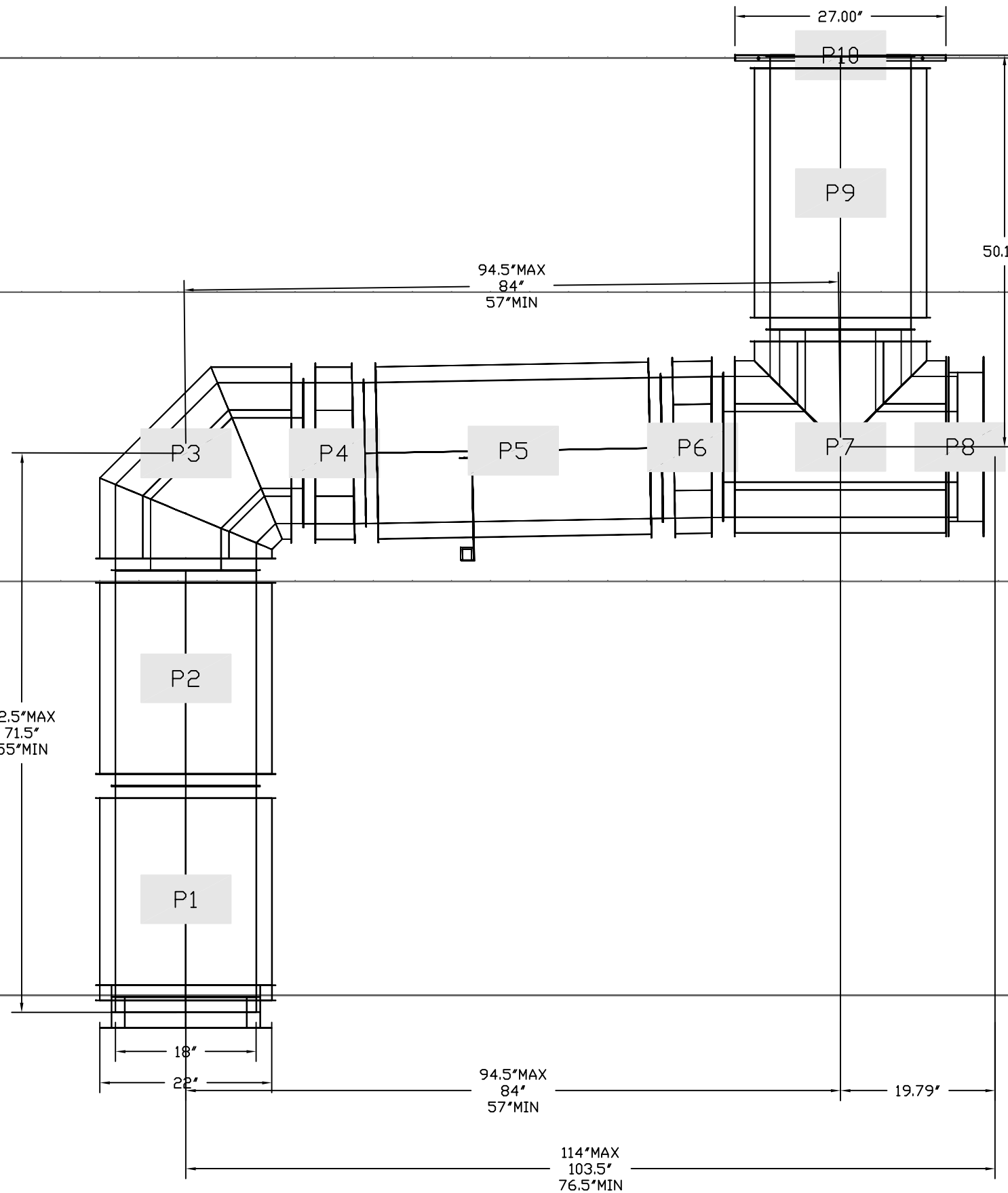

DUCTWORK #2 TOP VIEW DUCTWORK #2 SE VIEW

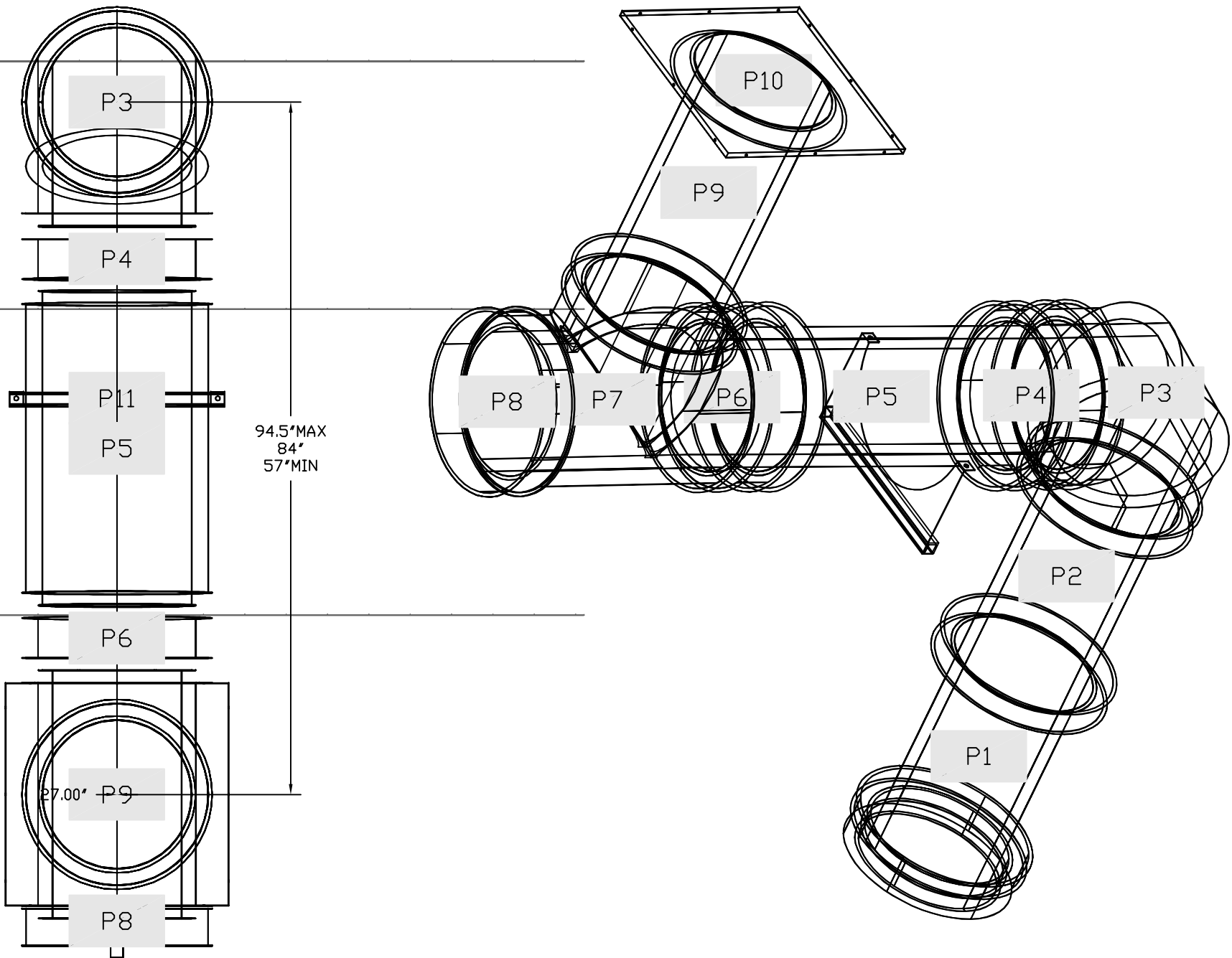

Floor (+0.00*AFF)

Ductwork is responsibility of
mechanical or general email reg83@captiveaire.com for pricing

NOTE: UNLESS OTHERWISE STATED, PANDA RESTAURANT GROUP SHALL PROVIDE ALL EQUIPMENT ON THE FOLLOWING CAPTIVEAIRE SHEETS, INCLUDING: HOODS, FIRE SYSTEM, EXHAUST FANS, SUPPLY FAN, BATHROOM FAN AND ELECTRICAL INTERLOCK PACKAGE.

DOUBLE WALL DUCT BY MECHANICAL PLEASE USE CONTACT BELOW FOR PRICING

ANSUL GAS VALVE:

THE ANSUL GAS VALVE IS PROVIDED BY CAPTIVEAIRE SYSTEMS. CONTACT OUR OFFICE WITH THE VALVE SIZE 3 DAYS IN ADVANCE OF WHEN IT IS NEEDED ON SITE.

FOR QUESTIONS CALL THE CAPTIVEAIRE SOUTHERN CA NATIONAL ACCOUNTS OFFICE

3002 DOW AVENUE, SUITE 410
TUSTIN, CA 92780
TEL: 714-677-2963 EMAIL: REG83@CAPTIVEAIRE.COM

KPI ENGINEERING, INC.
PROFESSIONAL ENGINEERS
"No matter the Scope, KPI has YOU Covered!"
3303 QUEEN PALM DRIVE
TAMPA, FLORIDA 33619
PHONE: (813) 241-6488
FAX: (813) 241-6488
BOARD OF PROFESSIONAL ENGINEERS - LICENSE # C-4470

REVISIONS

DESCRIPTION	DATE

www.captiveaire.com

Southern CA National Accounts
3002 Dow Ave., Suite 410, Tustin, CA 92780 PHONE: (714) 677-2963 EMAIL: reg83@captiveaire.com

Panda Express - Concord NC (D24956)
450 Kannapolis Parkway,
Concord, NC, 28027

DATE: 5/4/2023

DWG.#: 5986683

DRAWN BY: AH-83

SCALE: 3/4" = 1'-0"

MASTER DRAWING

SHEET NO. 12

PANDA EXPRESS, INC.
1683 Walnut Grove Ave.
Rosemead, California 91770
Telephone: 626.799.9898
Facsimile: 626.372.8288

REVISIONS:

ISSUE DATE:

CHECK SET	04-20-23
BID/PERMIT SET	06-01-23

DRAWN BY: BDG

PANDA PROJECT #: D24956
PANDA STORE #: TBD
ARCH PROJECT #: 239201

bdg architects
1501 W. Highway Dr., Suite 400
Tampa, FL 33602
www.bdgllc.com

SCOTT ROBERT NELSON, P.E.
NC LIC. # 049030

PANDA EXPRESS
PANDA HOME 2600
450 Kannapolis Parkway
Concord, NC 28027

M-411
HOOD DETAIL PLAN

PANDA HOME 2600 R3