

# CORNER RECORD

Agency Index

BK 115 PG 84

Document Number

CR 11960

City of EDEN TOWNSHIP

County of ALAMEDA, California

Brief Legal Description BRASS DISC MONUMENT WITHIN SALVIA DR.

## CORNER TYPE

## COORDINATES (Optional)

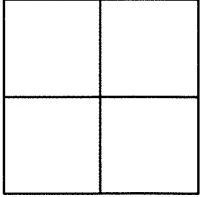

Government Corner ☐ Control ☒  
Meander ☐ Property ☐  
Rancho ☐ Other ☐

Date of Survey 6/15/18

N. 2074377± E. 6116519±

Elevation

Units Metric ☐ U.S. Survey Foot ☐

Horizontal Datum

Zone Epoch Date

Vertical Datum

☐ Complies with Public Resources Code §§8801-8819☐ Complies with Public Resources Code §§8890-8902PLS Act Ref: ☐ 8765(d) ☒ 8771 ☐ 8773 ☐ Other:

Corner/  
Monument: ☒ Left as found ☐ Established ☐ Rebuilt ☐ Pre-Construction  
☐ Found and tagged ☐ Reestablished ☐ Referenced ☒ Post-Construction

Narrative of corner identified and monument as found, set, reset, replaced, or removed:

☐ See sheet #2 for description(s) : SEE CR 11329

FOUND BRASS DISC WITH PUNCH IN CONCRETE IN MONUMENT WELL.

FOUND AND SET POINTS AS SHOWN ON PAGE 2.

THIS POINT WAS FOUND IN GOOD CONDITION AFTER A CONSTRUCTION PROJECT IN THE VICINITY.  
THE TIES SHOWN HEREON ARE FOR THE PURPOSE OF PERPETUATING FOUND MONUMENTATION.  
NO CLAIM IS MADE AS TO THE RELATIONSHIP OF THE POINTS OR LINES SHOWN HEREON TO TRUE  
BOUNDARY LOCATION.

## SURVEYOR'S STATEMENT

This Corner Record was prepared by me or under my direction in conformance with

the Professional Land Surveyors' Act on JUNE 22, 2018.

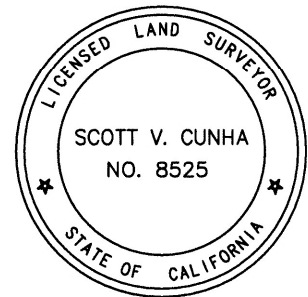
Signed SCOTT V. CUNHA P.L.S. or R.C.E. No. LS 8525

## COUNTY SURVEYOR'S STATEMENT

This Corner Record was received 24 JULY 2018

and examined and filed 18 OCTOBER 2018.

Signed MICHAEL RUBNER P.L.S. or R.C.E. No. 6843

Title COUNTY SURVEYOR

County Surveyor's Comment



SPEC-2353-Post

**LEGEND**

SCALE: 1"=30'

- FOUND BRASS DISC WITH PUNCH IN MONUMENT WELL  
STAMPED LS 5077
- ⊗ FOUND CUT CROSS IN WALK
- ✕ FOUND CUT CROSS IN CURB
- ⊗ FOUND MAG AND SHINER
- FOUND REBAR & CAP STAMPED "CEI RP"
- AA##A# ALAMEDA COUNTY MONUMENT ID
- (19592) REFERENCE STREET ADDRESS

