

CORNER RECORD

Agency Index

BK

118

PG

2

Document Number CR 12101

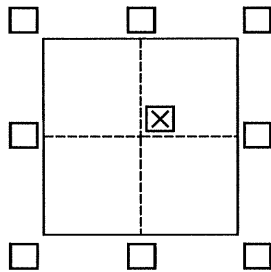
City of OAKLAND County of ALAMEDA, CaliforniaBrief Legal Description FOUND 1/4" IRON PIN MONUMENT AT 1045 GRANDVIEW DRIVE**CORNER TYPE**

Government Corner ☐ Control ☐
Meander ☐ Property ☒
Rancho ☐ Other ☐

Date of Survey August 29, 2018**COORDINATES (Optional)**N. E. Elevation Units ☒ Metric ☐ U.S. Survey Foot ☐Horizontal Datum Zone Epoch Date Vertical Datum ☐ Complies with Public Resources Code §§8801-8819☐ Complies with Public Resources Code §§8890-8902PLS Act Ref.: ☐ 8765(d) ☐ 8771 ☐ 8773 ☐ Other:

Corner/
Monument: ☒ Left as found ☐ Established ☐ Rebuilt ☒ Pre-Construction
☐ Found and tagged ☐ Reestablished ☐ Referenced ☐ Post-Construction

Narrative of corner identified and monument as found, set, reset, replaced, or removed:

☐ See sheet #2 for description(s):

Monument was found in good condition and was referenced with four set points as shown on page 2.

SURVEYOR'S STATEMENT

This Corner Record was prepared by me or under my direction in conformance with
the Professional Land Surveyors' Act on Dec. 19, 2018

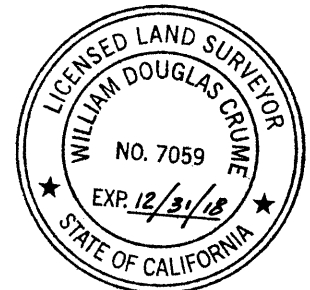
Signed [Signature] P.L.S. or R.C.E. No. 7059**COUNTY SURVEYOR'S STATEMENT**This Corner Record was received 5 SEPTEMBER 2018and examined and filed 24 JANUARY 2019Signed Michael Rubner P.L.S. or R.C.E. No. 6843Title COUNTY SURVEYOR

County Surveyor's Comment



LEGEND

FOUND 1/4" PIN, IN CONCRETE BASE DOWN
 1.1', IN STANDARD MONUMENT WELL; IN
 GOOD CONDITION

▲ SET MAG NAIL AND SHINER

