

CORNER RECORD

Agency Index BK 149 PG 99
Document Number CR 16270

City of Berkeley (APN : 56-1962-1) County of Alameda, California
Brief Legal Description City monument B0464 at Addison Street and 5th Street, near 800 Addison Street

CORNER TYPE

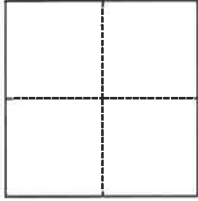

☐ Government Corner ☒ Control
☐ Meander ☐ Property
☐ Rancho ☐ Other

Date of Survey August 31, 2022

COORDINATES (Optional)

N. _____ E. _____

Elevation _____

Units ☐ Metric ☒ U.S. Survey Foot

Horizontal Datum _____

Zone _____ Epoch Date _____

Vertical Datum _____

☐ Complies with Public Resources Code §§8801-8819

☐ Complies with Public Resources Code §§8890-8902

PLS Act Ref.: ☐ 8765(d) ☒ 8771 ☐ 8773 ☐ Other:

Corner/
Monument: ☒ Left as found ☐ Established ☐ Rebuilt ☒ Pre-Construction
☐ Found and tagged ☐ Reestablished ☒ Referenced ☐ Post-Construction

Narrative of corner identified and monument as found, set, reset, replaced, or removed:

☒ See sheet #2 for description(s):

Found monument that could be damaged or destroyed by planned water line construction project. The monument was referenced as shown on page 2. The purpose of this Corner Record is to preserve possible evidence only; no attempt was made to determine the relationship to property, centerline, or right of way lines.

Reference EBMUD CR Book C, Page 162 (Doring/Chou)

SURVEYOR'S STATEMENT

This Corner Record was prepared by me or under my direction in conformance with

the Professional Land Surveyors' Act on October 13, 2022

Signed [Signature] P.L.S. or R.C.E. No. 8889



COUNTY SURVEYOR'S STATEMENT

This Corner Record was received _____

and examined and filed OCT 17 2022

Signed [Signature] P.L.S. or R.C.E. No. 7010

Title ALAMEDA COUNTY SURVEYOR

County Surveyor's Comment

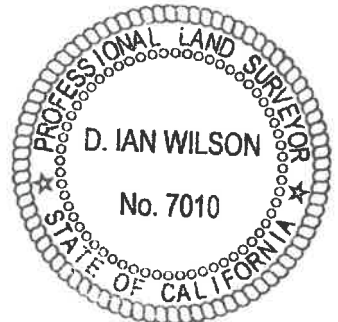

BERKELEY

ALAMEDA COUNTY

SISTERNA TRACT
7 M 43
BLOCK 95
14-18

19 M 79
BLOCK 94
11 10

FIFTH STREET

[99.80']
2.5' OFF JP

[99.98']
9.4' OFF HYD

ADDISON STREET

B0464

KF71R3

[100.00']

36.40'

36.07'

[100.60']
3' OFF DI

49.15'

[100.29']
2.9' OFF
BUILDING
CORNER

800 ADDISON STREET
APN: 56-1962-1

BERKELEY LAND AND
TOWN IMPROVEMENT
ASSOCIATION
19 M 79
BLOCK 107
4 & 5

7 M 43
BLOCK 106

LEGEND

FOUND 3/4" REBAR IN STANDARD MONUMENT WELL, 0.8' BELOW AC



FOUND SCRIBED CUT CROSS IN CONCRETE, NO RECORD



ASSUMED ELEVATION (MEASURED USING A LEICA DNA10 DIGITAL LEVEL)

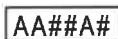

ALAMEDA COUNTY MONUMENT I.D.

ADDRESS: 800 ADDISON STREET

APN: 56-1962-1

SCALE
1"=30'

